

# SKAR-Sewage Combination Air Release Valve

## Features:

- . Advanced design with simple mechanism, strong float to prevent cracking during sudden water hammer & quick closure.
- . Aerokinetic mechanism to resist blow shut under higher air velocity even up to sonic velocity of air.
- . With special fat body design to lower the sewage water flow speed, and let the air out but keep sewage water underneath.
- . Keep dirty or corrosive liquid inside the body for safety during operation and no harm to human & surrounding environment
- . Internal body guide and upper round wall keep float moving on its rail and keep liquid turbulence flow within this area.
- . Much bigger air flow through the nozzle even for higher viscosity liquid.
- . Outside screen will be an option for safety and prevent insects or birds in.
- . Fully fusion epoxy coated inside and outside of valve body for long term services.
- . Manufacturing standard meets BS EN 1074-4, AWWA C512. Flange drilling and dimension meets BS EN 1092 and ANSI flange.

**S**KAR- Sewage combination air release valve Provides 3 functions:

- 1.Large air release during filling of the pipeline.
- 2.Small air venting under pressurized pipeline.
- 3.Large air intake during draining of the pipeline.



## Service Fields:

For sewage water system.

## Technical Data:

Size range: DN 50-200MM  
Pressure ratings: 1.0Mpa, 1.6Mp (Flange)  
Working temperature: -10°-80°C.  
Flow media: sewage water.

Please consult factory for PN25 and anti shock device whenever there is water hammer issue.

## Main Valve-DN50-200

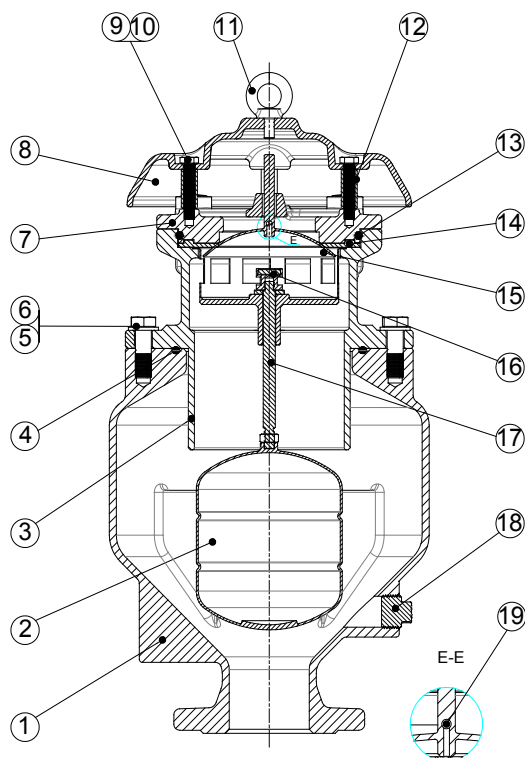

### Parts List

No.	Part Name	Material	Standard
1	Body	Ductile Iron	EN GJS 500-7
2	Float	Stainless Steel	AISI 304/316L
3	Middle Part	Ductile Iron	EN GJS 500-7
4	O-Ring	Rubber	NBR
5	Hex Bolt	Stainless Steel	AISI 304
6	Washer	Stainless Steel	AISI 304
7	Bonnet	Ductile Iron	EN GJS 500-7
8	Cover	Ductile Iron	EN GJS 500-7
9	Washer	Stainless Steel	Commercial/AISI 304/316
10	Hex Bolt	Stainless Steel	Commercial/AISI 304/316
11	Eyebolt	Carbon Steel	Commercial
*12	Pillar	Aluminium	Commercial
13	O-Ring	Rubber	NBR
14	Seat	Rubber	NBR
15	Sealing Arc	Stainless Steel	AISI 304/316L
16	Orifice Seat	Rubber	NBR
17	Stem	Stainless Steel	AISI 304/316L
18	Plug-Option	Stainless Steel	AISI 304/316L
19	Small Orifice	Stainless Steel	AISI 304/316L

\* Size  $\geq$  DN150 have no pillar.

## Dimension

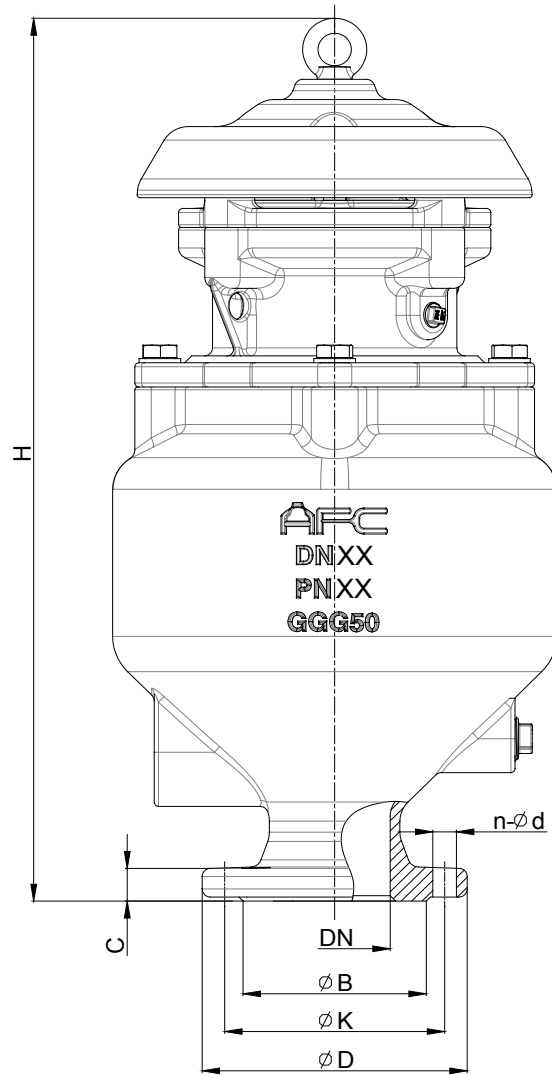

Unit: MM

DN	Model No.	H	ØD		ØK		ØB		n-Ød		C
			PN10	PN16	PN10	PN16	PN10	PN16	PN10	PN16	
50	SKAR-0050	558	165	125	99	4-Ø19	19				
80	SKAR-0080	653	200	160	132	8-Ø19	19				
100	SKAR-0100	676	220	180	156	8-Ø19	19				
150	SKAR-0150	810	285	240	211	8-Ø23	19				
200	SKAR-0200	950	340	295	266	8-Ø23	12-Ø23	20			

\* AFC keeps the right to change dimension without further notice.

# BIG NOZZLE EXHAUSTING / INTAKE

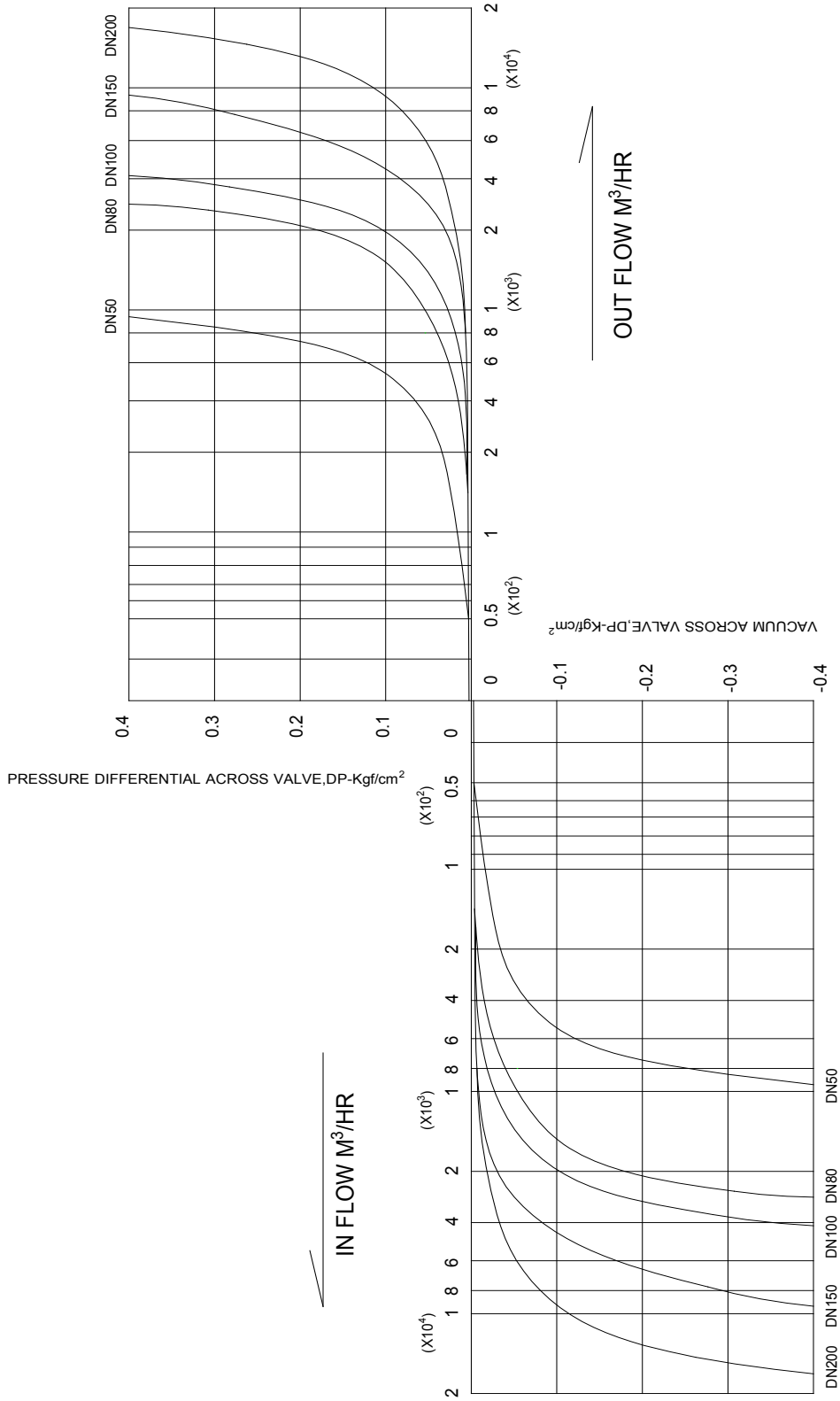

# SMALL ORIFICE VENTING

## Combination Air Release Valve air venting capacity

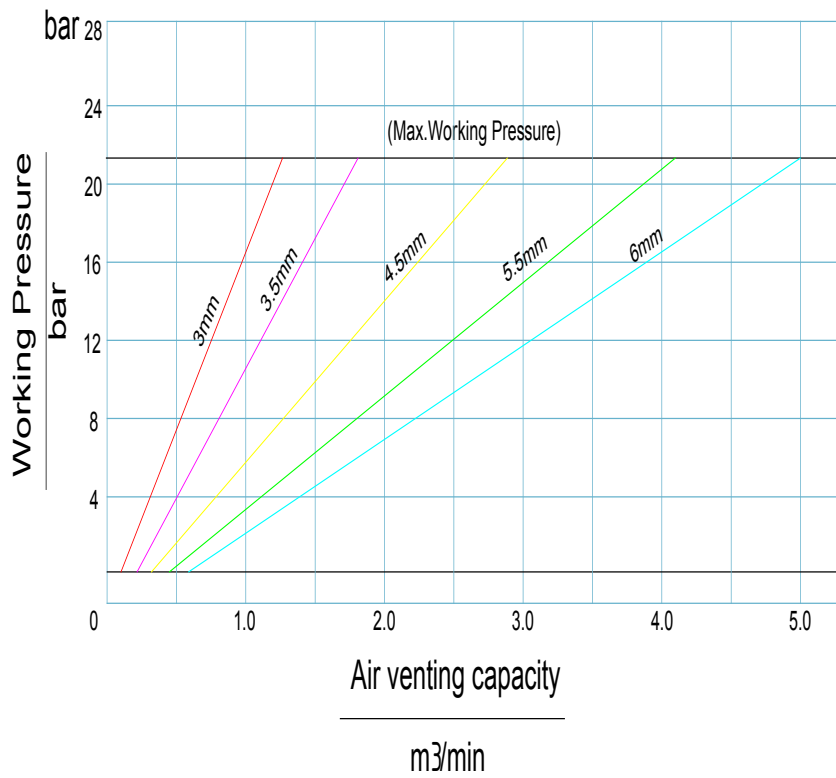

## SKAR-Quick Selection Table

Water flow rate range Max.CMH (M <sup>3</sup> /Hour)	1,360	4,160	8,500	19,100	33,400
Main pipe size MM	80-400	400-700	750-1000	1050-1500	1500-2000
Inlet size of SKAR MM	50	80	100	150	200
Small orifice size	3.0	3.5	4.5	5.5	6

## Ordering Code

Model:

SKAR- Sewage combination air valve  
SKAV-Kinetic air/vacuum valve, with 2 functions, for large air exhaust and intake

SKA R - 0200 - 16

